

TO ALL RESIDENTS OF THE VILLA BELMONT COMMUNITY.

LOCATE THE *#'S ON THE MAP AND READ THE INSTRUCTIONS BELOW FOR THAT CORRESPONDING *#.

- * (1) 3 parking spots will be needed at the end of this lot.
- * (2) 3 parking spots will be needed at the end of this lot.
- * (3) The dead end at the end of this parking lot will need to remain open. (between the pool and the back of building #68)
- * (4) All parking spots will be needed at the pool area of this parking lot. (at the pool across from building #76)
- * (5) 4 parking spots will be needed at the end of this lot.
- * (6) The area opposite the parking spots of this lot will need to remain open. (#72 south entrance side)

- Park vehicles within the striped lines - away from curb.
- Be cautious when driving or walking in the Community.
- **Be a good neighbor!** Don't remove cones that don't belong to you AND don't park in spaces not cleaned by you.
- You may use ICE MELT located in dumpster rooms, but please do not remove containers from that room.
- Remember cones must be removed within three (3) days of storm.

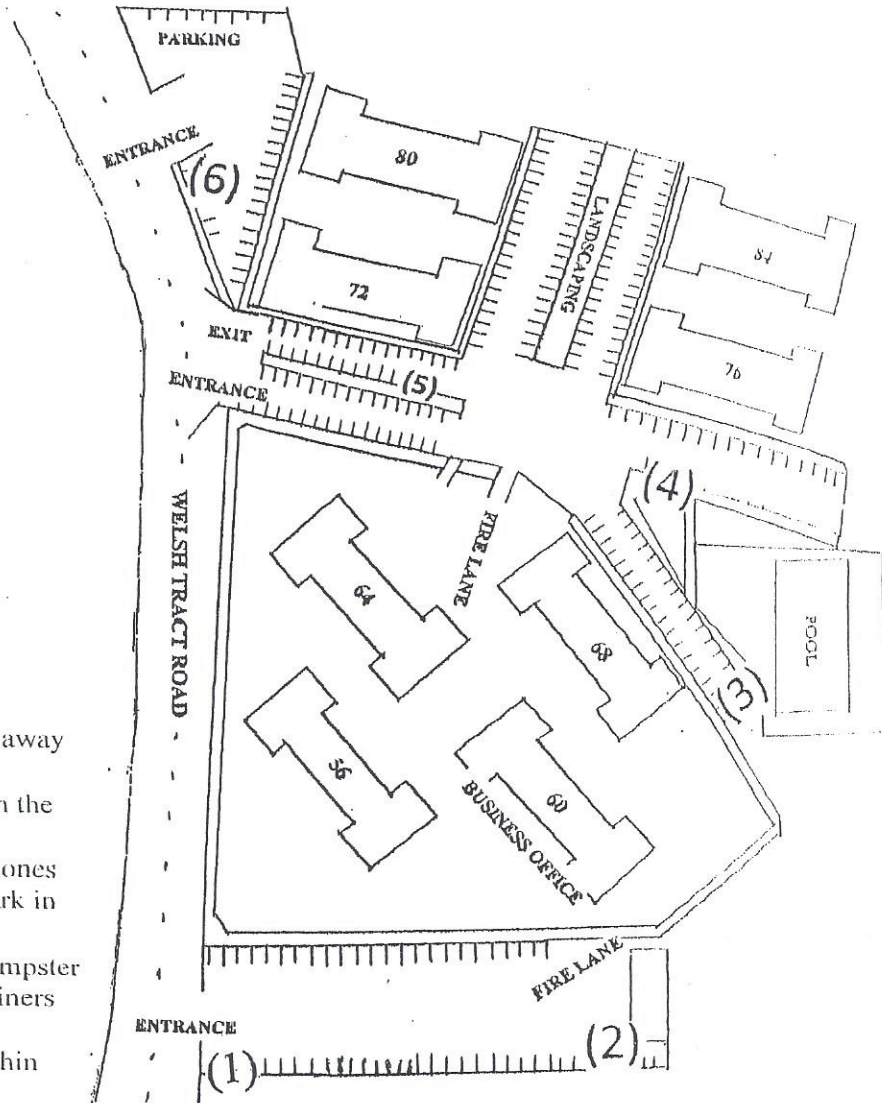

ANY VEHICLE BLOCKING A DESIGNATED SNOW AREA WILL BE TOWED, WITHOUT WARNING, AT THE OWNERS EXPENSE!

ALSO, REMEMBER IF YOU PARK IN A FIRE LANE, ON A SIDEWALK, OR ANY AREA THAT IS NOT A DESIGNATED PARKING SPOT YOU WILL BE TOWED.

WE ONLY CLEAR THE DRIVING AREA OF THE LOTS.

WE DO NOT CLEAR PARKING SPOTS.

IF YOU SHOULD SHOVEL OUT A PARKING SPOT AND WANT TO SAVE IT THEN YOU MUST ADHERE TO THE FOLLOWING GUIDELINES.

- WHEN SHOVELING THE SNOW FROM AND AROUND YOUR VEHICLE, DO NOT PLACE IT ONTO OR UNDER OTHER VEHICLES, THE DRIVING AREA OF THE LOT THAT HAS BEEN PLOWED OR THE SIDEWALK THAT HAS BEEN SHOVELED.
- YOU ARE PERMITTED TO SAVE THE SPOT WITH CONSTRUCTION CONE(S) ONLY.
- THE CONE MUST BE PLACED AT THE END OF THE SPOT NEAREST THE DRIVING AREA OF THE LOT (NOT IN THE DRIVING AREA OF THE LOT).
- WE HOPE THAT ALL THE RESIDENTS WILL ACT IN A MATURE MANNER AND NOT PARK IN A SPOT THAT WAS NOT CLEARED BY THEM.
- IF YOU SHOULD ENCOUNTER AN ALTERCATION WITH A NEIGHBOR OR A GUEST OF A NEIGHBOR YOU NEED TO CALL THE NEWARK CITY POLICE DEPARTMENT. OUR STAFF WILL SUPPLY THE POLICE DEPARTMENT WITH ANY INFORMATION THEY MAY NEED ABOUT THE PERSONS INVOLVED.
- THE VBCA STAFF WILL NOT GET INVOLVED IN DISPUTES OVER PARKING, UNLESS THE PARKING ISSUE IS A DIRECT VIOLATION OF THE RULES & REGULATIONS!